

Reconstruction of North Street

(from Stage Road to Pescadero Creek Road)

May 20, 2015

County of San Mateo
Department of Public Works



Agenda

- Project Overview & Project Limits
- Existing Conditions
- Project Elements & Constraints
- Proposed Road Improvements
- Proposed Process and Timeline
- Questions, Comments, and Input



Project Description

- Objective - replace existing road with new road of approximately the same widths and elevations
- The Project limits - North Street from Stage Road to Pescadero Creek Road
- Road Length .92 mile

Project Location



 AREA OF PROPOSED ROAD IMPROVEMENTS



Existing Conditions

- Road Widths – 24' and 20'
- The existing road right-of-way varies from 45 to 60 feet
- Pavement Condition Index is 2



Road Width – 24'



From Stage Road to curve at approx. 323 North Street &
from Curve at approx. 150 North Street to Pescadero Creek Road

Road Width – 20'



From curve at approx. 323 North Street to curve at approx. 150 North Street

Existing Bridge



Current Traffic Count Map

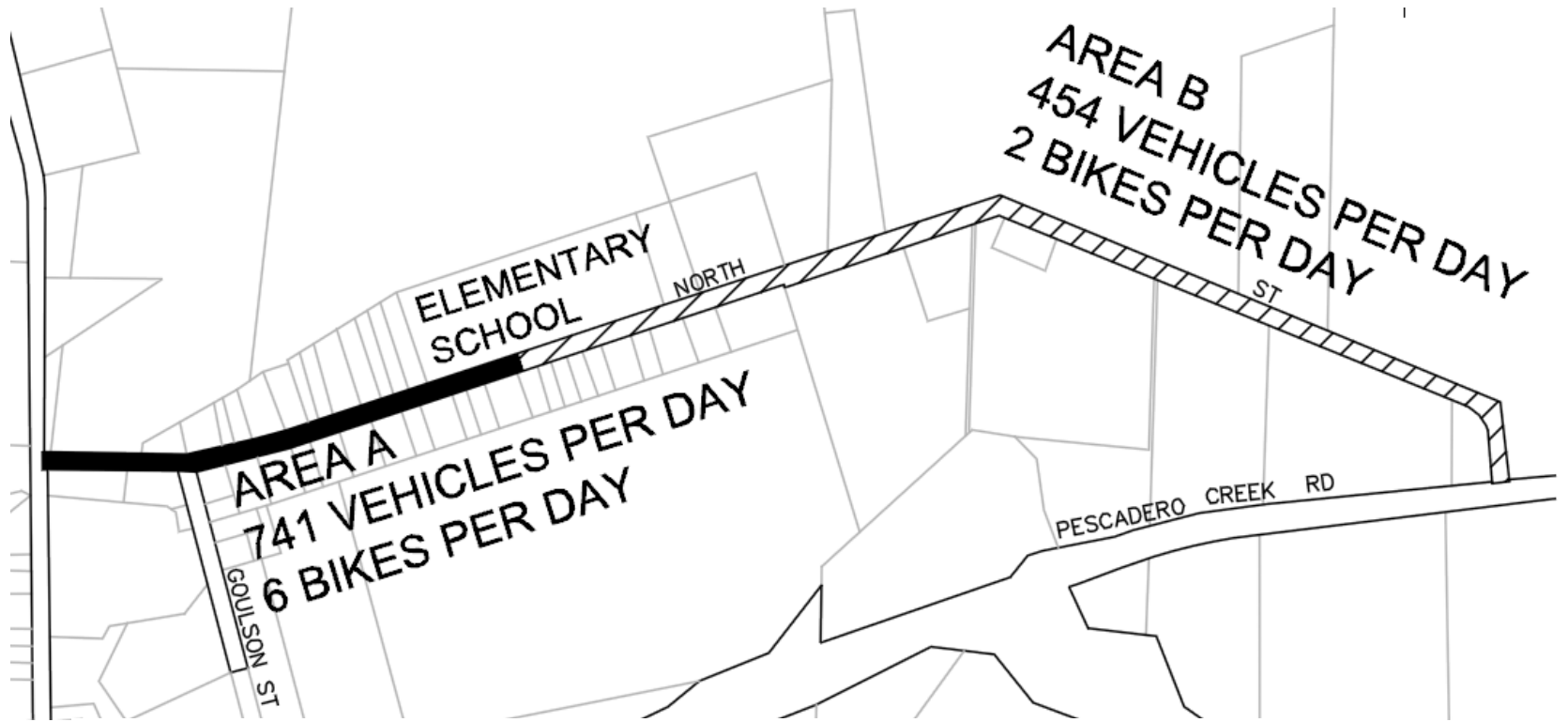

TRAFFIC COUNTS FROM FRIDAY, JAN 16, 2015 – THURSDAY, JAN 22, 2015

 AREA A – STAGE ROAD TO ELEMENTARY SCHOOL

 AREA B – ELEMENTARY SCHOOL TO PESCADERO CREEK ROAD



Current Speed Data Map

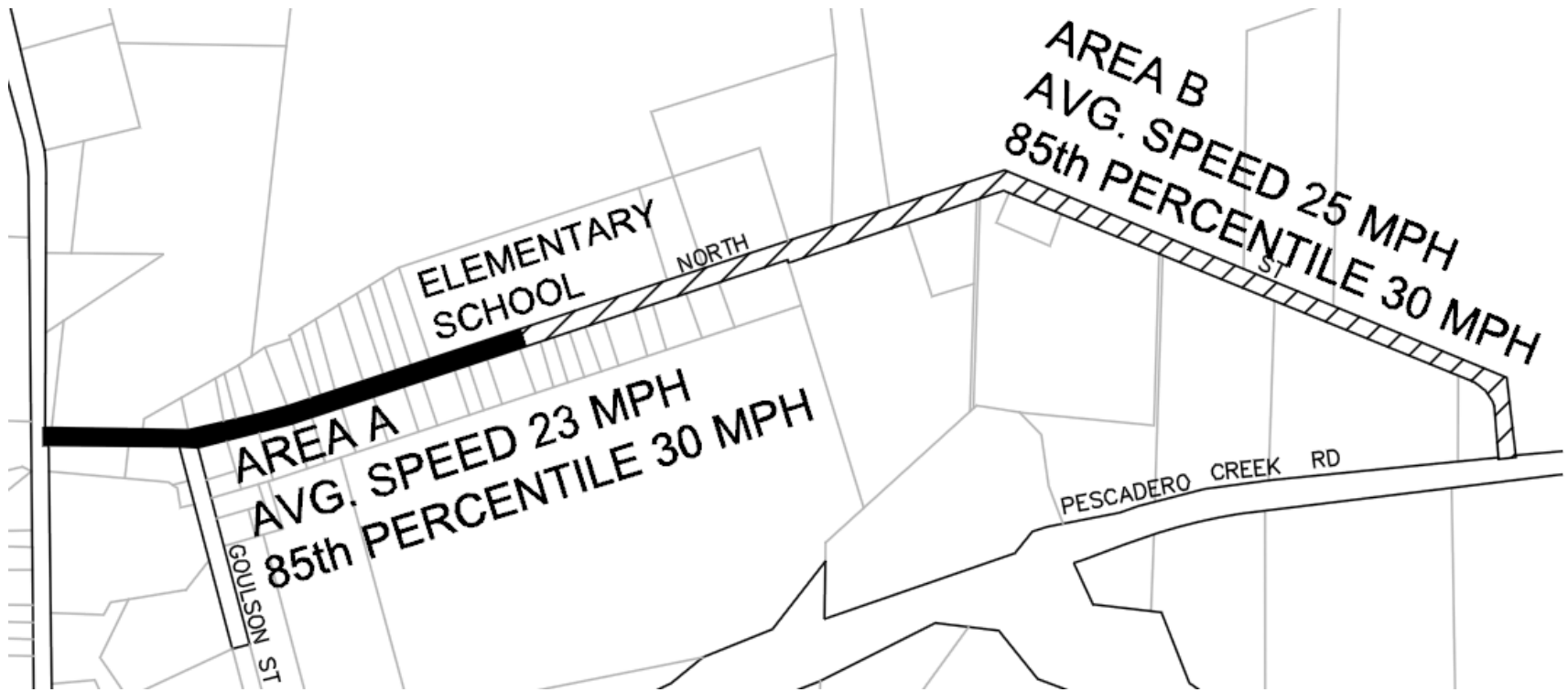

SPEED DATA FROM FRIDAY, JAN 16, 2015 – THURSDAY, JAN 22, 2015

 AREA A – STAGE ROAD TO ELEMENTARY SCHOOL

 AREA B – ELEMENTARY SCHOOL TO PESCADERO CREEK ROAD

County Speed Control Devices Criteria

- A minimum 85th percentile speed of 32 mph is required
- Approval by California Highway Patrol
- For further information go to:
<http://publicworks.smcgov.org/traffic-speed-and-parking>



Project Elements & Constraints

- Existing road does not have a structural section
- Environmentally sensitive areas for both plants and animals
- Drainage ditches and culverts along side of road
- Maintain existing drainage patterns



Drainage Ditches along side of road



Drainage Ditches are environmentally sensitive areas that will need to be protected during construction

Proposed Road Improvements

- Remove & replace existing drainage pipes that cross North Street (12” to 15” diameter)
- Reconstruct road using cement treated base (1’)
- Paving road (0.2’ or about 2.5”)
- Placement of shoulder backing material
- Cross Valley Gutter near bridge – existing low point
- Bicycle “Sharrows”



Proposed Road Improvements (cont.)

- Two High visibility yellow ladder type crosswalks
 - Add Crosswalk near school
 - Remove Existing Crosswalk near Bridge
- Push button flashing pedestrian signs at both sides of crosswalks
- Signs to be installed (pedestrian, school, and speed limit)
- Estimate 35 working days for construction

Drainage pipes to be replaced across North Street



Dash lines show location of existing 12" CMP drainage pipe to be replaced with 15" HDPE drainage pipe

Drainage pipe to be replaced across North Street



Dash lines show location of existing 12" CMP drainage pipe to be replaced with 15" HDPE drainage pipe

Existing and Proposed Road Widths

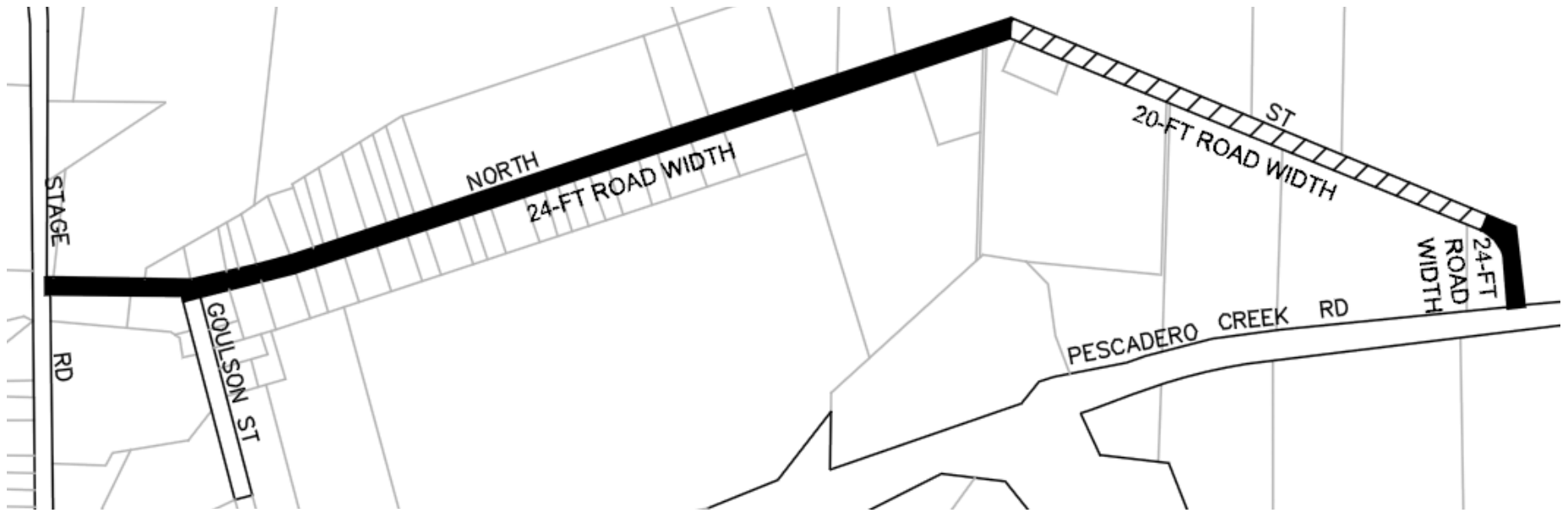

 24' ROAD WIDTH

 20' ROAD WIDTH

The project will replace existing road with new road of approximately the same widths and elevations

Cement Treatment Operation (1')



Asphalt Paving Operation (0.2' or about 2.5")



Shoulder Backing Material



Shoulder backing material will be placed where rock currently exists

Bicycle “Sharrows”

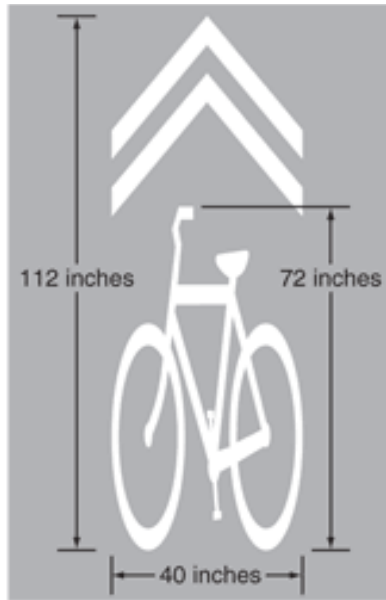

Bicycle “Sharrows”
Pavement Marking



Markings shall be placed **4 feet** from edge of pavement and spaced at intervals of **250 feet** along the road

High visibility yellow ladder type crosswalks (Total 2 at School)



Ladder Type Crosswalk

Push button flashing pedestrian signs at both sides of crosswalks – 4 total



Signs to be installed



2 signs to be removed and replaced 500 feet in advance of school



2 signs to be installed 100 feet in advance of uncontrolled crosswalk



4 signs to be removed and replaced at existing locations



2 signs to be installed in advance of the bridge

Centerline Paint replaced with Pavement Markers



Remove Existing Crosswalk



Existing Crosswalk
to be removed

How will this project affect access during construction?

- Contractor must coordinate schedule with school to minimize disruption
- Contractor work hours generally 8 am to 5 pm
- Cement treat and paving work may be phased to minimize disruption to elementary school
 - Phase 1 between Stage Road through the elementary school
 - Phase 2 between the elementary school through Pescadero Creek Road



Proposed Process & Timeline

- **Spring 2015**: Design project
- **Late Summer 2015**: Advertise and bid project
- **Fall 2015**: Project construction



Estimated Project Cost

- **\$800,000**
- **To be paid for by Road Mitigation Fund and Road Fund**



Questions, Comments, and Inputs

Contact:

Matthew Ruble

mruble@smcgov.org

650-363-4100

Gil Tourel

gtourel@smcgov.org

650-363-4100

More info at:

<http://publicworks.smcgov.org/reconstruction-north-street>



Thank you!

